

## ACCU POWER LINE

EFFECTIVE AND EFFICIENT

### AS 1200

- 1-13 m
- 0.5 - 10 bar
- Spray time 0.28 - 5.7 h
- 18 V / 2 x 10.0 Ah



### REB 15 ACT

- 15 liters
- 0.5 - 6 bar
- 0.2 - 1.4 l/min<sup>1</sup>
- 18 V / 4.0 Ah



In the world of Birchmeier, You have chosen an equipment from the leading Swiss manufacturer of spraying, foaming, and misting. At the core of all our activities are the functionality and reliability of our products and your satisfaction.

Battery-operated sprayers and misting machines offer several advantages for various applications, including agriculture, pest control, sanitation, and more.

**PORTABILITY AND MOBILITY:** Allow users to move freely and reach remote or difficult-to-access areas.

**EASE OF USE:** Operators don't need to manually pump or carry heavy loads, which can be physically demanding.

**INCREASED EFFICIENCY:** They can cover a larger area quickly and consistently, ensuring even distribution of liquids.

**PRECISION AND CONTROL:** Allow operators to control the volume and coverage of the liquid or mist. This precision can be crucial for specific applications.

**REDUCED ENVIRONMENTAL IMPACT:** Produce fewer emissions and are often more environmentally friendly compared to gas-powered alternatives.

**REDUCED NOISE LEVELS:** Important for applications in urban or noise-sensitive areas, e.g., schools and hospitals.

**LESS MAINTENANCE:** There is no need for fuel, oil changes, or complex engine maintenance.

**CONSISTENCY IN APPLICATION:** Can maintain a consistent pressure and flow rate, resulting in uniform application.

**SAFETY:** Eliminate the risks associated with gasoline or diesel fuel, such as spills, fumes, and fire hazards. They are generally safer for both operators and the environment.

NEW



## ONE BATTERY, MANY SOLUTIONS

- Unlimited combinations: devices, battery pack and chargers of all CAS\* partners
- Cross-manufacturer compatibility for over 300 devices
- Different 18 V battery packs obtainable (up to 10 Ah)
- REC 15 without battery pack and charger available

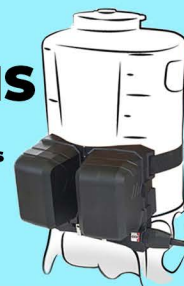

**REB15 (PRESSURE CONTROLLED BATTERY BACKPACK SPRAYER)**

- **TANK VOLUME:** 15 Liters
- **PRESSURE RANGE:** 7 - 43.5 PSI (0.5 - 3 Bar)
- **PRESSURE LEVELS:** Continuously adjustable
- **BATTERY PACK:** 18 Volts Lithium-Ion / 2.0 Amperes
- **BATTERY PACK CHARGING TIME:** Less than 80 mins.
- **SPRAY PERIOD PER BATTERY PACK CHARGE:** 2.4 – 7 hours
- **SPRAY OUTPUT PER BATTERY PACK CHARGE:** 70 – 105 Liters
- **TYPE OF PUMP:** Diaphragm pump 12V DC
- **PUMP PERFORMANCE:** (AT 0 BAR AND MAX BAR): 3.1 Liter / min. | 2.3 liter/min.
- **MAX SPRAY OUTPUT:** 1.9 Liter / min.
- **SPRAY OUTPUT (AT 2 BAR / POS. SPRAYING):** 0.4 liter / min.
- **NOZZLES:** Round Nozzle 1.7mm (Adjustable) & Fanjet nozzle 8002 PP Viton
- **GASKETS / FITTINGS:** FPM (Viton) / NBR, Ms
- **HOSE LENGTHS:** 1.3 meter
- **SPRAY LANCE:** 60 cm length, made of brass
- **TRIGGER VALVE:** Heavy duty trigger
- **EMPTY WEIGHT:** 10.35 kilograms
- **DIMENSIONS (L x W x H):** 240mm x 340 mm x 570mm
- **STRESS CLASS:** 2-Heavy Duty

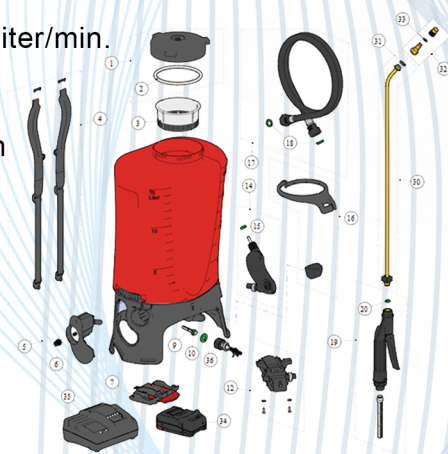

**Fanjet 8002**

Indoor Residual spraying  
WHO Recommended  
Min.: 0.46 l/min  
Max.: 0.79 l/min



**Fanjet 8002**

Min.: 0.30 l/min  
Max.: 0.49 l/min



**Lithium-Ion Battery**  
18 Volts / 2.0 Amperes



**Single Battery Charger**  
"AIR COOLED"

**AS1200 (BATTERY OPERATED BLOWER)**

- **VOLUME FLOW:** Maximum 1200 cubic meter per hour
- **BLOWING FORCE:** Maximum 19 Newton
- **RANGE:** 1-13 meters
- **AIRSPPEED LEVELS:** 1-5 plus turbo level (max.)
- **PRESSURE RANGE:** 0.5-10 Bar
- **BATTERY PACK:** 2pieces Lithium-Ion 18 Volts / 10.0 Amperes
- **BATTERY RUNNING TIME:** 25 min. to 6 hours maximum (Blower level 1-5)
- **BATTERY CHARGING TIME:** 70 min.
- **LIFE SPAN BATTERY:** Up to 1000 charging cycles or 3 years
- **WEIGHT:** 6.5 kilograms
- **DIMENSION (L x W x H):** 46mm x 160mm x 304mm
- **NOZZLES:**

- AITXA 8001 VK
- AITXA 8002 VK
- AITXA 8003 VK
- NF 125

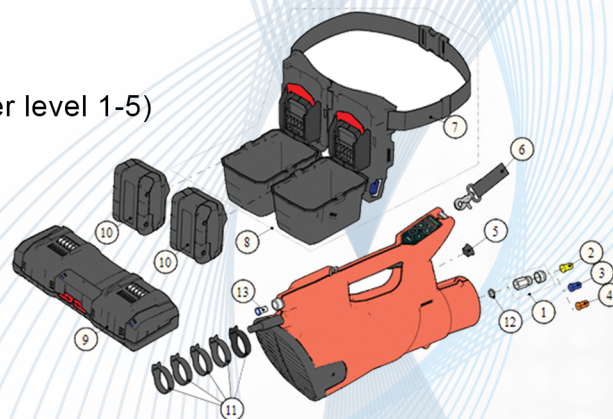

**NF 125**

Ultra Low Volume  
Min.: 25 microns  
Max.: 125 microns



**8002 VK**

Spraying Nozzle  
Min.: 0.46 l/min  
Max.: 1.44 l/min



**8003 VK**

Spraying Nozzle  
Min.: 0.68 l/min  
Max.: 2.16 l/min



**8001 VK**

Spraying Nozzle  
Min.: 0.23 l/min  
Max.: 0.72 l/min



**Lithium-Ion Battery**  
18 Volts / 10.0 Amperes



**Double Battery Charger**  
"AIR COOLED"